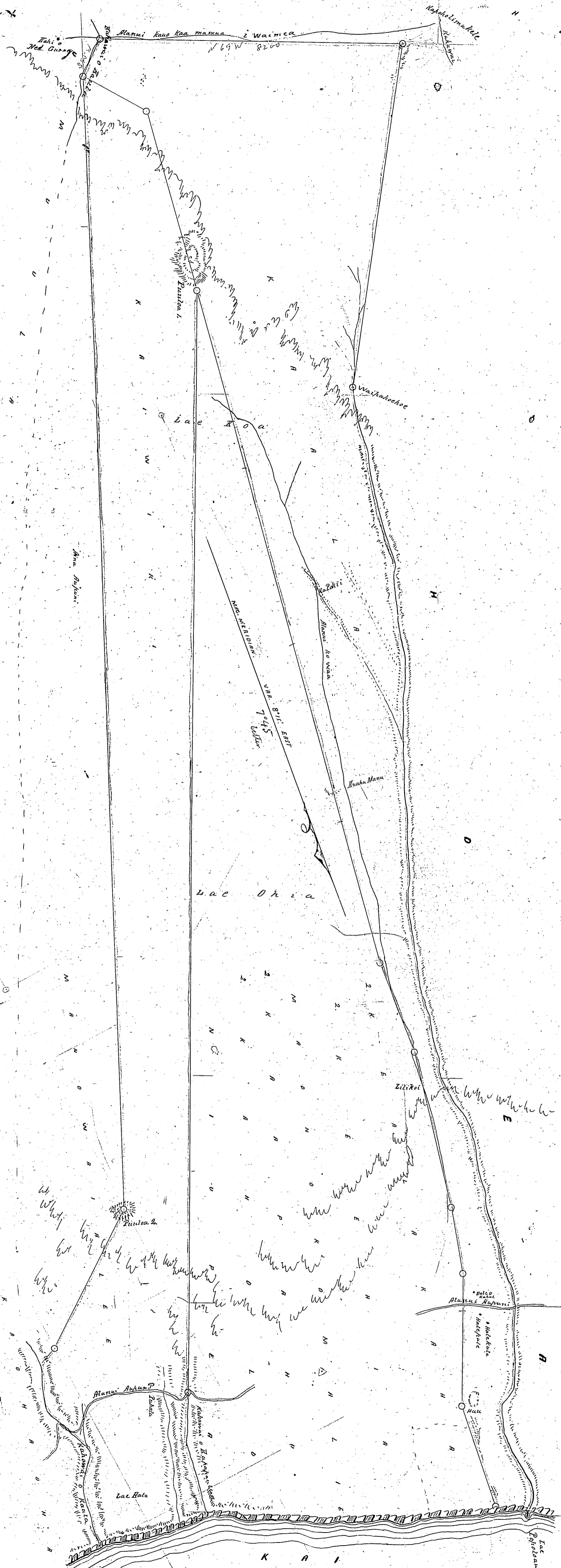

Exhibit B  
 Filed March 7/92  
 Honolulu  
 Dpty. Clerk

KAALA AND KAIWIKI  
 HAMAKUA, HAWAII  
 C. J. Lyons 1853

1:2400

T.M.K. 4-1-03, 04, 06 (Kaala)  
 T.M.K. 4-1-01, 05, 06 (Kaiwiki)



*Apana 6*

KAALA  
 HAMAKUA - HAWAII

E hoomaka ana ma kahi kumu oia ma ka pali kahakai, e pili ana me kaalaka ma ka Hikiro iho o kahi alu kahawai, a e pili ana ma ka palena o kaalaka, He. 1°11' 10" 2850 Kap. a ka paku ma ka Hi. o kahi kahawai, o pili ana ma ka ala kaan alaila He. 2°50' 10" 5610 Kap. a ka pohaku kaalaka K. 1100 Kap. mauka o ka ala aupa alaila He. 10' 10" 1840 Kap.; alaila He. 7' 10" 4350 Kap. pili ana ma ka kumu kahakai ma Lili'koi, alaila He. 0' 50' 2590 Kap.; alaila He. 5' 10" 24,100 Kap. a puka iwaho o ka lala laau mauka, (ma 19,000 oia, hui me Kaiwiki); alaila He. 40' 50" 1940 Kap. a hiki i kahawai o Kaala, alaila ma ia kahawai ma ka palena o Hilo, He. 4' 10" 1100 Kap.; a hiki i ka paku ma ka alanui kahiko kele ana ma Humuwa i Waimea, alaila He. 69' 10" 8200 Kap. a hiki i ke kahi Kom. o Keia, ma ka pohaku kaalaka ma ka lala laau ma ka Hi. o kahawai o ka Kaholomukela, (ma nei paku a Papahiki He. 55' 10" a i Tuu Maluhaha He. 17' 10"); alaila iho ana i kai He. 28' 10" 900 Kap. a hiki i ke alu pohaku ma Waipahoehoe, mauka iho o kahi pahi, alaila iho ana ma kahawai a hiki i kahakai i ka lala o Poptoau; alaila ma kahakai a hiki i kahi i hoomaka. Maloko o Keia 2482 Cha

\*Pili ana ma Puloa

*Apana 7*

KAIWIKI  
 MANDWAILEE  
 HAMAKUA - HAWAII

E hoomaka ana ma kahi kumu ka kaalaka ma ka ala o Puloa. mauka ma ka hui o Keia me Kaala, a e pili ana ma Puloa He. 5' 10" 5100 Kap. ma Kaala a puka iwaho o ka lala laau, alaila He. 40' 50" 1940 Kap. a hiki i ka paku ma kahawai o Kaala, alaila iho ana i kai ma ka ala aupa Kap. He. 18' 10" 5090 Kap. a hiki i Puloa-2. ma ka lala laau o ka lala laau, alaila He. 47' 10" 4220 Kap. a hiki i kahakai ma puka, alaila He. 62' 10" 600 Kap. a hiki i kahawai o Kaala, alaila iho ana ma ia kahawai ma ka palena o Hilo, a hiki i kahakai, alaila ma kahakai a hiki i kahawai o Kupaaula 5020 Kap. alaila pili ana ma ia kahawai ma ka palena o Poptoau a hiki i kahi e puka a ke alanui aupa; alaila He. 20' 50" 30,000 Kap. a hiki i kahi i hoomaka. Maloko o Keia 2214 Cha.

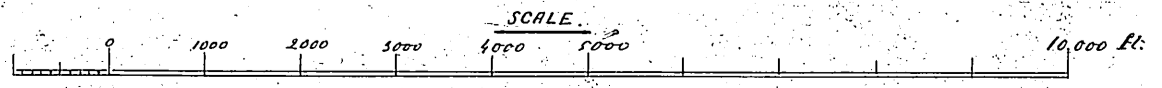

C. J. LYONS.

NOV. 1853.

Req. 38  
 Dr. 2 no. 8